



# Full HD Webcam

## TLL491131

### User manual

This manual is available in more languages on [www.tellur.com/manuals](http://www.tellur.com/manuals)



**INTO YOUR FUTURE**

## Product description

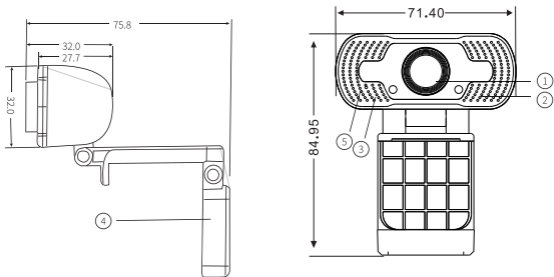

1. Lens
2. Power indicator
3. Signal indicator
4. Multi-functional bracket
5. Microphone

## **Technical specifications**

Image sensor: 1/2.7 2MP

Video resolution: 1920x1080 (Full HD)

Video frame rate: 30 fps

Focus type: Autofocus

Built-in microphone: Yes

Field of view: 97°

Audio encoding format: PCM

Encoding format: MJPEG

Power supply: USB DC 5V

Cable length: 150cm

Features: Privacy cover, Automatic low light correction

Compatible with: Windows® 10 or later,

Windows 8, Windows 7, Mac OS

Dimensions: 85 x 71.4 x 32 mm

Weight: 98g

Color: Black

Package includes: 1 x Web camera, 1 x Manual

## Setting up your webcam

Place the webcam on your computer's monitor or desktop.

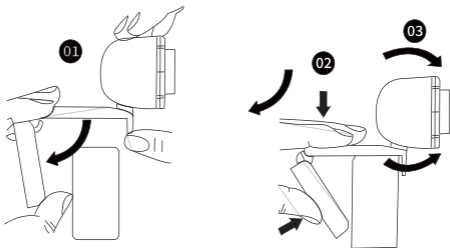

### Monitor mounting

Take the webcam as shown in the picture above and open the clip base with your other hand. Mount the webcam making sure the base of the clip is firmly fixed on the back of your monitor.

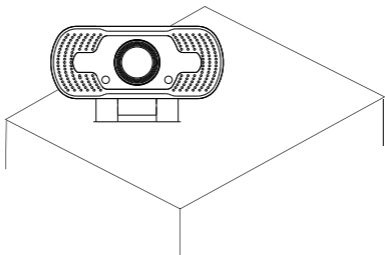

## Connecting

Plug your webcam into a PC USB port. The webcam will install automatically in ~1 minute.

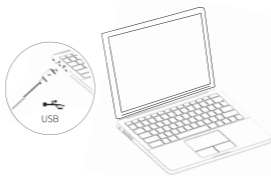

## Getting started with video calling

To take advantage of video calling, both you and the person you call must install a videoconferencing app, such as Skype, Teams, Zoom, Messenger or Gmail. In addition, both callers will need:

- A computer with speaker (or a headset) and a microphone - your webcam has an integrated microphone;
- A broadband Internet connection;
- Please check your preferred videoconferencing app requirements. Requirements may vary between different apps, but usually a minimum of 2Mbps upload speed is required.

## Q&A

**Q: How do I know if my camera is recognized by the operating system?**

A: Connect the camera in any USB 2.0/3.0 port. Once connected, the camera needs a few moments to be recognized by the system. To ensure the camera was installed correctly, check: Control Panel -> Systems and Security -> Device Manager.

**Q: How do I know if my videoconferencing app is compatible with my webcam?**

A: All videoconferencing apps allow you to review the audio and video devices they're using. Go to your preferred videoconferencing app and check:

- The Audio settings to ensure the USB 2.0 camera microphone is selected. If not, select USB 2.0 camera.
- The Video settings to ensure the USB 2.0 camera is selected. If not, select USB 2.0 camera.

## Disposal and recycling information



The crossed-out wheeled-bin symbol on your product, battery, literature or packaging reminds you that all electronic products and batteries must be taken to separate waste collection points at the end of their working lives; they must not be disposed of in the normal waste stream with household garbage.

It is the responsibility of the user to dispose of the equipment using a designated collection point or service for separate recycling of waste electrical and electronic equipment (WEEE) and batteries according to local laws. Proper collection and recycling of your equipment helps ensure EEE waste is recycled in a manner that conserves valuable materials and protects human health and the environment, improper handling, accidental breakage, damage, and/or improper recycling at the end of its life may be harmful for health and environment.